

## SIGNING SCHEDULE

Customer: <i>Wessex Water</i>	Site: <i>Priority Cottage Hankerton</i>
Number of standard signs <i>27.</i>	Number of special signs:
Number of operatives: <i>1</i>	Number of vehicles: <i>1.</i>
Designed by: <i>Bernie Turley</i>	Design date: <i>28-7-20.</i>

ALL SIGNS ARE TO CARRY SUN TRAFFIC LOGO

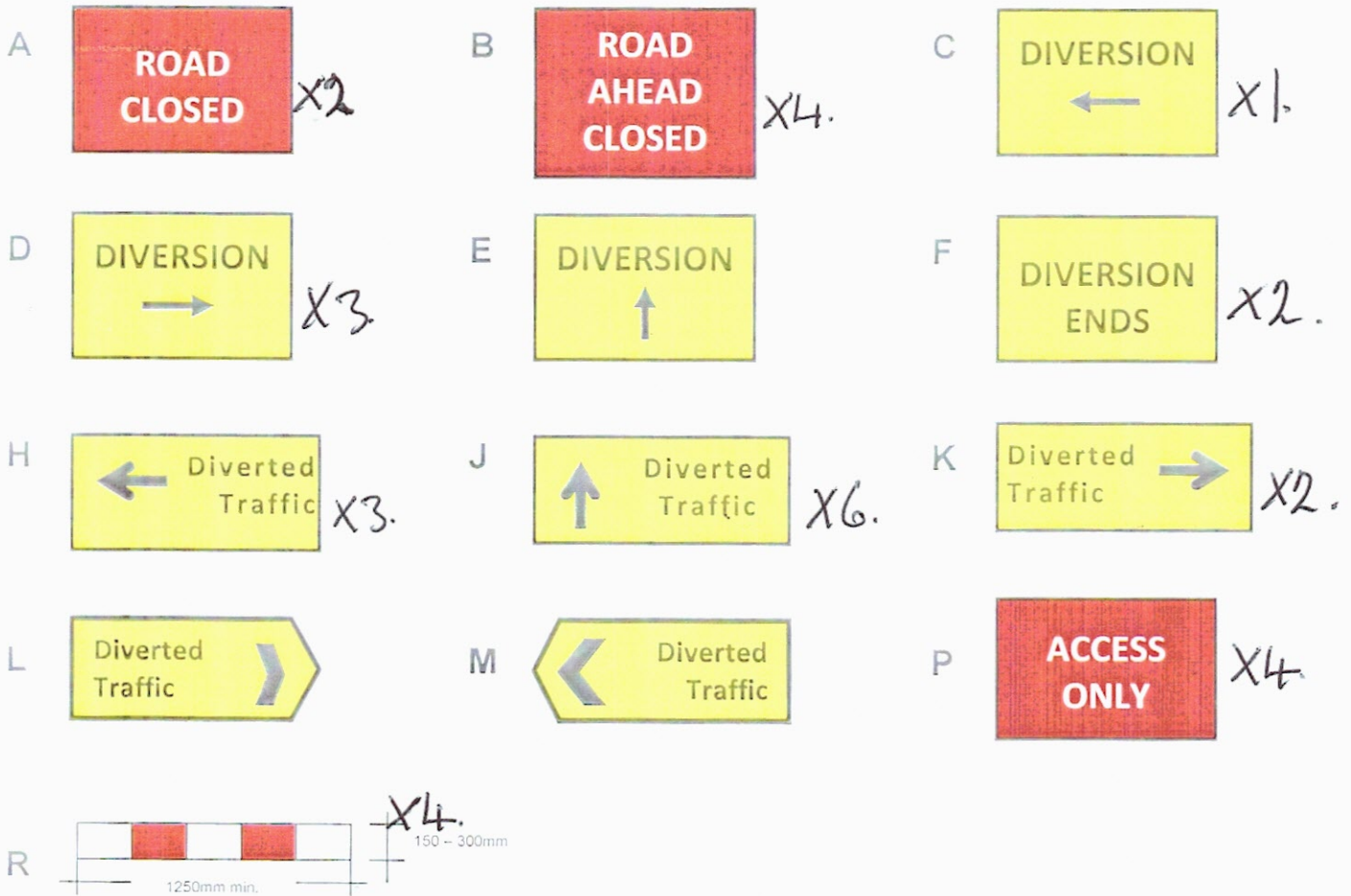

To Extend Full Width Of Construction / Closure  
 Alternate White/ Red Bars

### NOTES

Signs C – F to be used at the beginning of closure

Signs A and R (Full width of carriageway) to be placed at limits of closures

All sign positions indicated on plan are approximate. Sizes are applicable to residential roads.

Sizes to be increased on high speed roads.

Signing details shown are MINIMUM requirement. (Excludes Chapter 8 signing). Further signs may be required in response to unforeseen site conditions/circumstances.

The TM operative(s) shall ensure all freestanding temporary signs are made secure by the use of sacks filled with a fine granular material and coned.

ALL SIGNS TO BE TSRGD COMPLIANT

ALL SIGNS TO BE WEIGHTED WITH SANDBAGS

ALL SIGNS TO HAVE ROAD CONES ADJACENT

R1.  
SN169 5Z  
Wiltshire, England, United Kingdom

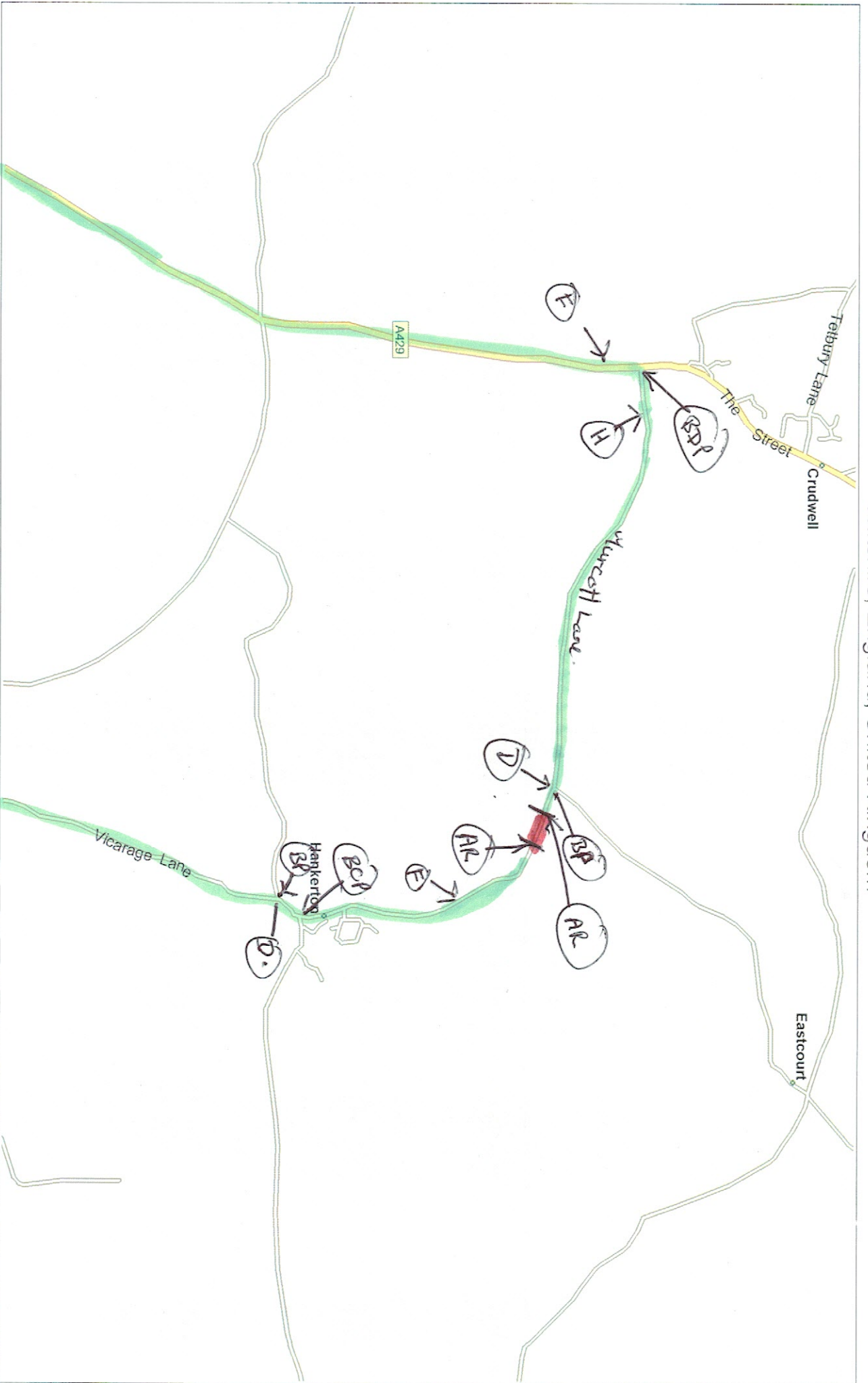

P2 SN1695Z.

Wiltshire, England, United Kingdom

